



AssayAssure® Multilock Instructions

Please read prior to use

Thank you for your interest in Sierra Molecular's Multilock. AssayAssure® Multilock provides a sample preservation and a transport medium for cells, tissue, saliva, feces, skin cells, and swab surfaces. Multilock has been sold under the name Multiplex and Bioservative. Below are brief instructions for use for multiple methods of sample capture and storage. Follow with the analysis method of choice. This is a quick reference guide – more detailed instructions are on all of our product packaging.

Universal Pre-Collection Steps

1. Thoroughly wash and dry hands prior to start.
2. When working with any mammalian fluids or cells, wearing gloves and eye protection is always recommended.
3. Do not ingest or expose to eyes or sensitive skin.

Instructions by collection/Sample Method

For sample stabilization and further analysis: A ratio between 10:1 to 11:1 is typical and can be analyzed with or without being centrifuged, depending on your research needs.

For swab sampling: We recommend using break-away swabs for sampling. DO NOT touch or lay the white swab tip down during the entire collection process. To avoid possible contamination of sample, DO NOT touch the bottom one-half of the swab shaft. DO NOT wet the swab with the transport liquid before applying swab to sample area. The swab MUST BE DRY for sample collection. Swabs (with sample) can be placed directly into the Multilock solution. Use enough Multilock to insure that the swab remains covered. See figure below:

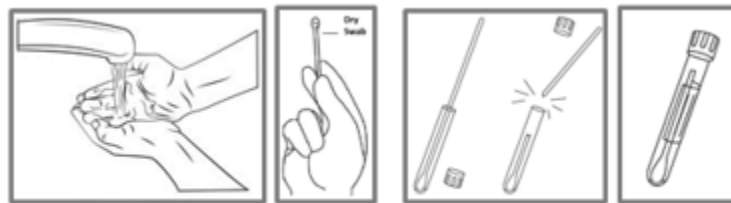

Figure A

Figure B

Figure C

Figure D

Preserved samples can be stored or shipped at room temperature for days to weeks (depending on test matrix and analyte). AssayAssure® Multilock is readily available in the following formats:

Tubes: 5 ml, 15 ml, and 50 ml – individually bagged, 100 per case.

Bulk bottles: 15 ml, 100 ml, 230 ml, 1 L, and 9.5L.

Please contact us for further information: info@sierramolecular.com